

Daily Cleaning Instructions: KL16 Series

Clean the following components at least once daily. Clean more frequently if your pharmacy dispenses many dust-generating medications or if you experience counting errors.

Materials: 70% isopropyl alcohol, lint-free cloth and water.

Do not use facial tissue, cotton balls or cotton swabs to clean the unit.

Before starting, unplug the unit.

1. Top Funnel

- Remove the top funnel and middle channel from the unit.
- Clean outside and inside thoroughly with alcohol.

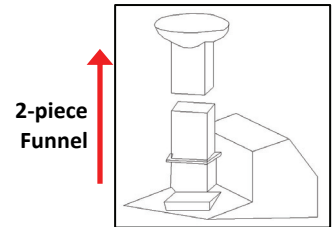

2. Glass Detector Windows

The unit's counting sensors are located behind four glass windows inside the square funnel hole. **Most counting errors are caused by pill dust accumulating on the edges and corners of the windows. Clean the windows well.**

- Wipe off excess pill dust on the detector windows with a **dry** lint-free cloth.
- Wet a clean cloth with alcohol and clean the inside of the four glass windows thoroughly to remove all remaining dust and residue. Carefully wipe back-and-forth, not up-and-down.
- Do not press hard as this may break the glass windows. Broken windows are not covered under the warranty.
- Wipe glass windows dry with clean cloth to remove alcohol streaks.

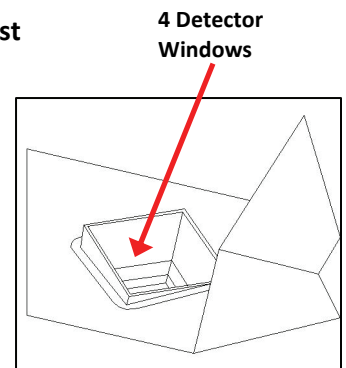

3. Counting Tray (KL16 only)

- Carefully remove the clear plastic tray cover. Clean all parts thoroughly with a water-dampened cloth (not alcohol). Wipe dry. Replace the tray cover.
- Turn the tray over, and wipe the silver sensor strip with a water-dampened cloth (not alcohol).

4. Tray Sensor (KL16 only)

- (Located on the bottom of the unit in back of the counting tray.) This sensor detects the tray's silver sensor strip, telling the unit that the tray is properly seated.
- With the counting tray removed, tip the unit carefully to access the tray sensor. Clean with a water-dampened cloth (not alcohol).

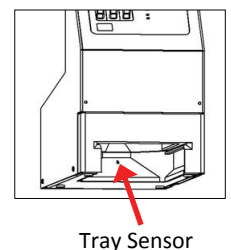

5. Black Lower Funnel (KL16df only)

- Unscrew the black lower funnel. Clean the interior thoroughly with alcohol. Dry black funnel's interior thoroughly.
- Clean the silver exit gate with alcohol and a lint-free cloth. Dry thoroughly.
- Reassemble only when parts are dry.

6. Cleaning and Troubleshooting

Problem or Error Code	Probable Cause	Possible Solution(s)
E-2, E-4, E-5 or E-6	Tablet dust or residue on detector windows.	Clean detector windows thoroughly.
E-9, O-S, or unit counts by itself	Tablet dust or residue on detector windows, cracked detector window, or possible detector board failure	Clean detector windows thoroughly. If error persists, contact Service.
Miscounts	Tablet fragments, or tablet dust or residue on detector windows.	Check counted medications for tablet fragment(s); clean detector windows thoroughly.
KL16 Only: Display reads “---“ instead of “000” with tray pushed in	Tray not fully inserted. Tray sensor window is dirty. Silver sensor strip on bottom of tray is peeling or worn.	Fully insert counting tray; clean tray sensor window (damp cloth, not alcohol); replace silver sensor strip. If error persists, contact Service.
KL16 Only: Display flickers	Tray sensor window is dirty.	Clean tray sensor window (damp cloth, not alcohol).

As-Needed Maintenance

7. Cleaning the Touch Screen and Fingerprint Scanner

- A. Touch Screen – carefully clean with a non-ammonia glass cleaner or a computer screen cleaner and a clean, lint-free cloth. Do not spray directly onto the screen. Instead, spray onto the cloth first.
- B. Fingerprint Scanner – carefully clean with alcohol. Do not spray directly onto the fingerprint scanner. Instead, spray onto the cloth first.

7. Cleaning the Exit Front (KL16 only)

Periodically, the exit front may need cleaning to clear the counting tray's guide tracks.

- To remove, hold the exit front at both sides and pull firmly so that it releases from its locked position. Slide the exit front out.
- Clean the guide tracks and exit front with alcohol and cloth. Dry thoroughly.
- To replace the exit front, slide it back into the machine until it locks in position.

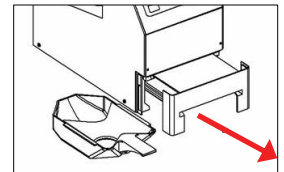

8. Help Video and Questions

A short cleaning demonstration video can be viewed at <http://www.kirbylester.com/pharmacy-technology-service-tablet-counters.htm>. If you still have questions, please contact Kirby Lester Service at 800.243.2465 or service@kirbylester.com.